

Flat A, 1 Erroll Street,

Peterhead, AB42 1PU

Price Over

£70,000

 2
  1
  1
 
 80 m²
 EPC D
 Council Tax Band A



Contact Solicitor

Masson & Glennie LLP
 Broad House, Broad Street
 Peterhead
 AB42 1HY

01779 474271

katrina.argo@massonglennie.co.uk

<https://www.massonglennie.co.uk>



Features

Description

Literally 'on the doorstep' of the town centre this **first floor flat** is sure to be of interest to those looking for a 'first time buy' or an entrepreneur looking for the ideal property to let. Recently redecorated and with a newly installed kitchen and bathroom this home is in 'ready to move into condition'. Viewing is highly recommended to appreciate the accommodation and location on offer.

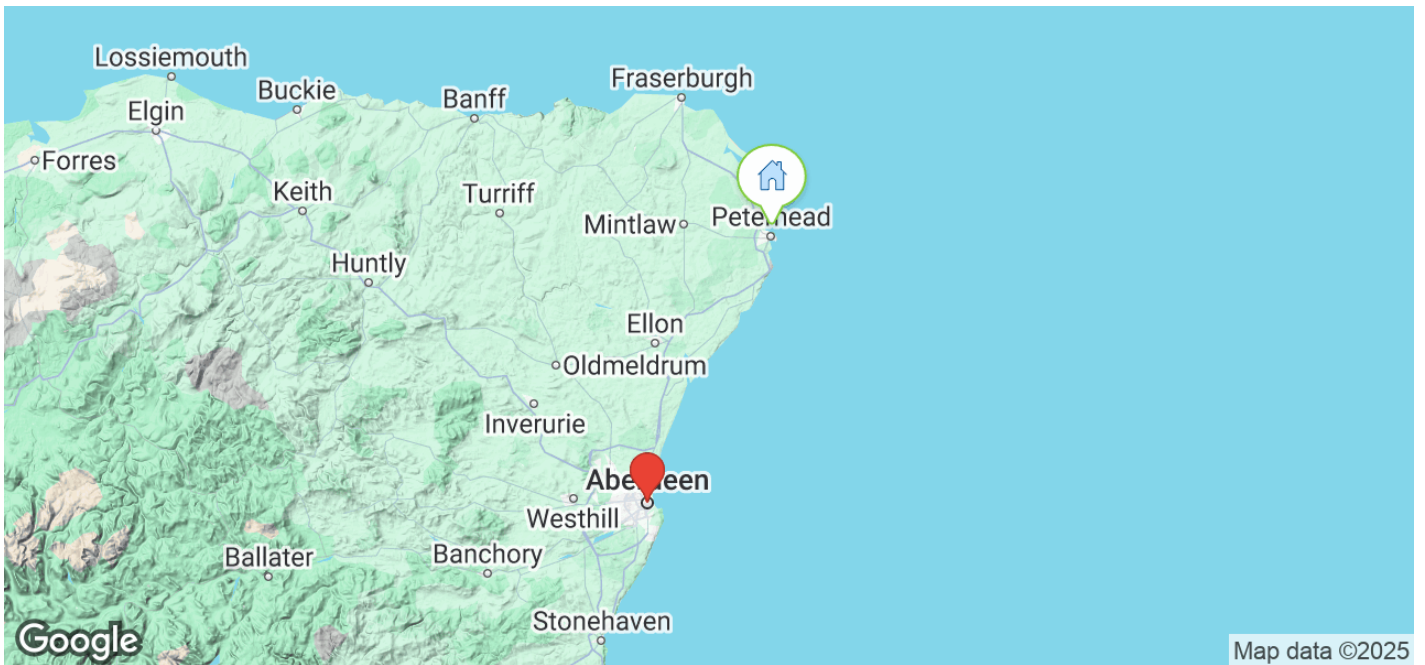

Accommodation comprises

Lounge: 4.29m x 4.26m (14'1" x 14') approx.

Dining Kitchen: 4.26m x 3.98m (14' x 13'1") approx.

Bedroom 1: 4.26m x 2.74m (14' x 9') approx.

Bedroom 2: 3.65m x 2.74m (12' x 9') approx.

Bathroom: 2.76m x 1.54m (9'1" x 5'1") approx.

(Outside)

Loft

Shared Court Yard

(Other Information)

Gas Central Heating, Double Glazing.

Client has recently installed a new boiler to the property.

Moveable items:

All floor coverings, curtains and light fittings to be included in the sale.

Floorplan

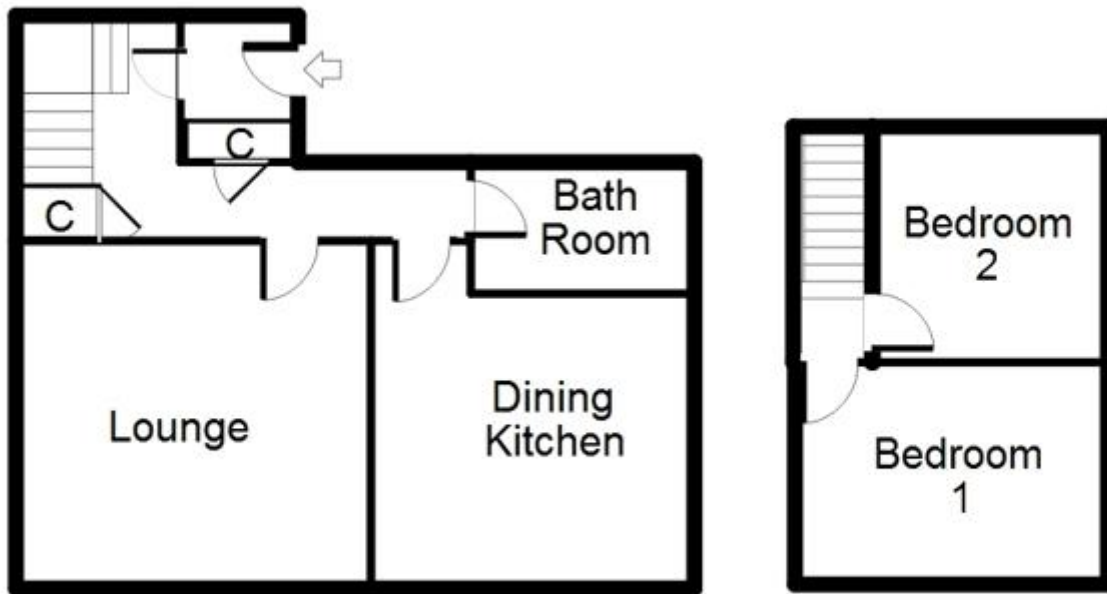

Photo gallery



View this property here

<https://www.aspc.co.uk/search/property/352930/Flat-A--1-Erroll-Street/Peterhead/>

The foregoing particulars are being distributed on behalf of the Selling Solicitors by Aberdeen Solicitors' Property Centre Ltd. of 2-10 Holburn Street, Aberdeen, AB10 6BT. Whilst the particulars have been prepared with care and are believed to be accurate, no liability for any errors or omissions therein or the consequences thereof will be accepted by the Selling Solicitors or Aberdeen Solicitors' Property Centre Ltd. © Aberdeen Solicitors' Property Centre and Selling Solicitors.